

EG4[®] CHARGEVERTER POWER CORD-120V

USER MANUAL



1. INTRODUCTION

The EG4® Chargeverter Power Cord-120V is designed to easily support 120V/15A input and provide up to 25A/1425W of battery charging power. This cord ensures seamless compatibility when using a standard 120V receptacle. Perfect for users who need flexibility in their charging setup where 240V input is not available. The EG4 Chargeverter Power Cord-120V comes preconfigured to support connectivity to the Chargeverter GC and Plus.

2. PACKING LIST

The following item will be in the box. Before installation, inspect the contents to ensure the component was not damaged in transit.



EG4 Chargeverter Power Cord (×1)
61.5" length
1.6 lbs. weight

3. INSTALLATION

EG4® has made an easy swap for those who need a 120V charging option instead of the 240V option that is provided. Follow the steps below for correct installation:

Step 1: Locate the twist lock connector on the NEMA 14-30 cord (if installed) where it connects to the AC input on the Chargeverter. Next, twist the connector counterclockwise to release the cord from the Chargeverter.

Step 2: To attach the NEMA 5-15 cord, insert the twist lock plug into the AC input port on the Chargeverter. Twist clockwise until the connector is securely fastened. The installation is complete and ready to be plugged into a standard 120V/15A household receptacle.

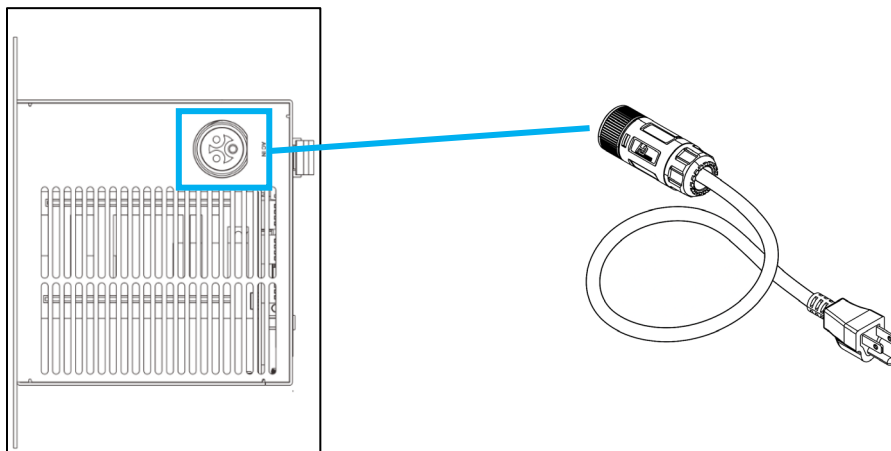

4. CONNECTION INFORMATION

The charger's maximum output current is dependent on the input AC voltage and wall receptacle's rating, as shown in the following table:

Charger Input AC Voltage/Receptacle	Maximum DC Output Current
120VAC/15A	25.2 Amps
120VAC/20A	31.5 Amps



CAUTION:

If using a 15A wall receptacle, ensure the max DC output current is set no greater than 25.2A. If using a 20A wall receptacle, ensure the max DC output current is set no greater than 31.5A. Do not use more than the recommended charging current for the Chargeverter. This can lead to tripped breakers and or component damage.

CHANGELOG

2-19-26

- Published v1.0.2
- Added Chargeverter Plus compatibility

12-19-24

- Published v1.0.1
- Added cable length to packing list
- Added cable weight to packing list

12-5-24

- First revision released



CONTACT US

support@eg4electronics.com

(903) 609-1988

www.eg4electronics.com